

CRINAN HOUSE TYPE

13/4 House • 4 Bedrooms

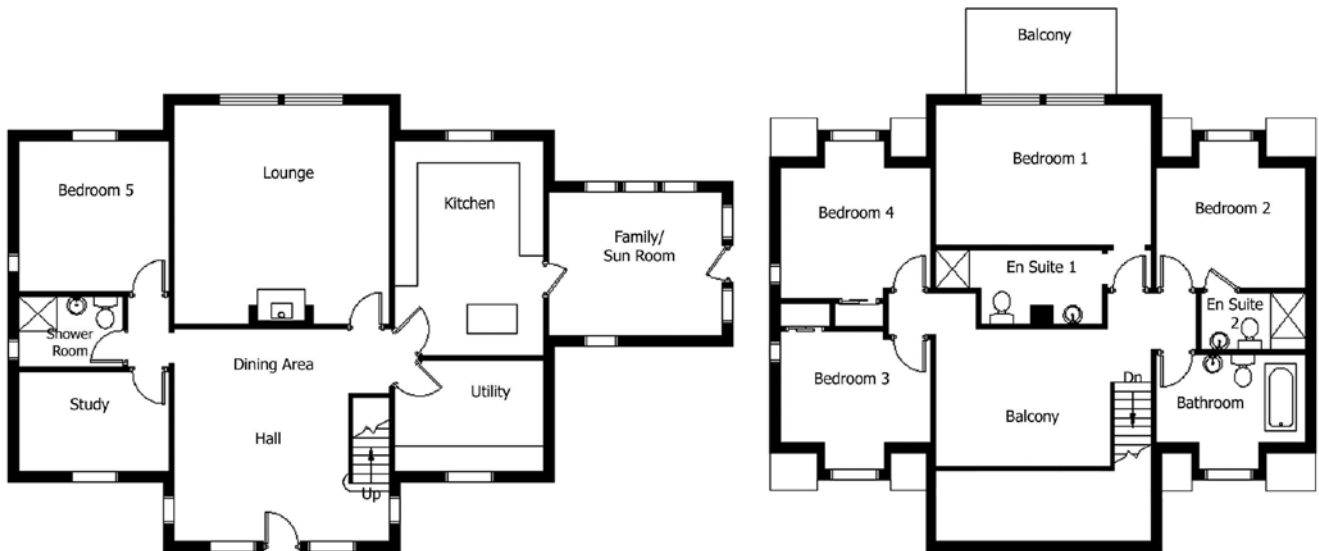

For illustrative purposes only. Not to scale.
Plan indicates property layout only.



Crinan	Metres	Feet	Crinan	Metres	Feet	Floor Area: 246m2 Frontage: 20.1m Depth: 11.7m Ridge Height: 8.3m
Lounge	5.4 x 5.5	17'8" x 18'0"	Bedroom 1	5.4 x 3.6	17'9" x 11'10"	
Family Room	4.3 x 3.6	14'1" x 11'10"	Bedroom 2	3.7 x 3.0	12'1" x 9'10"	
Kitchen	3.7 x 5.5	12'1" x 18'0"	Bedroom 3	3.7 x 2.8	12'1" x 9'2"	
Study	3.7 x 2.6	12'1" x 8'6"	Bedroom 4	3.7 x 3.3	12'1" x 10'10"	
Utility	3.7 x 2.8	12'1" x 9'2"	Bedroom 5	3.7 x 3.8	12'1" x 12'5"	
Bathroom	3.7 x 2.1	12'1" x 6'10"	En-suite 1	3.1 x 1.9	10'2" x 6'3"	
Shower Room	2.6 x 1.8	8'6" x 5'11"	En-suite 2	2.6 x 1.5	8'6" x 4'11"	

The information on this leaflet is for guidance only and does not constitute an offer or form any part of any contract.