

TIRIODH (chir-ee-a) HOUSE TYPE

Bungalow • 3 Bedrooms

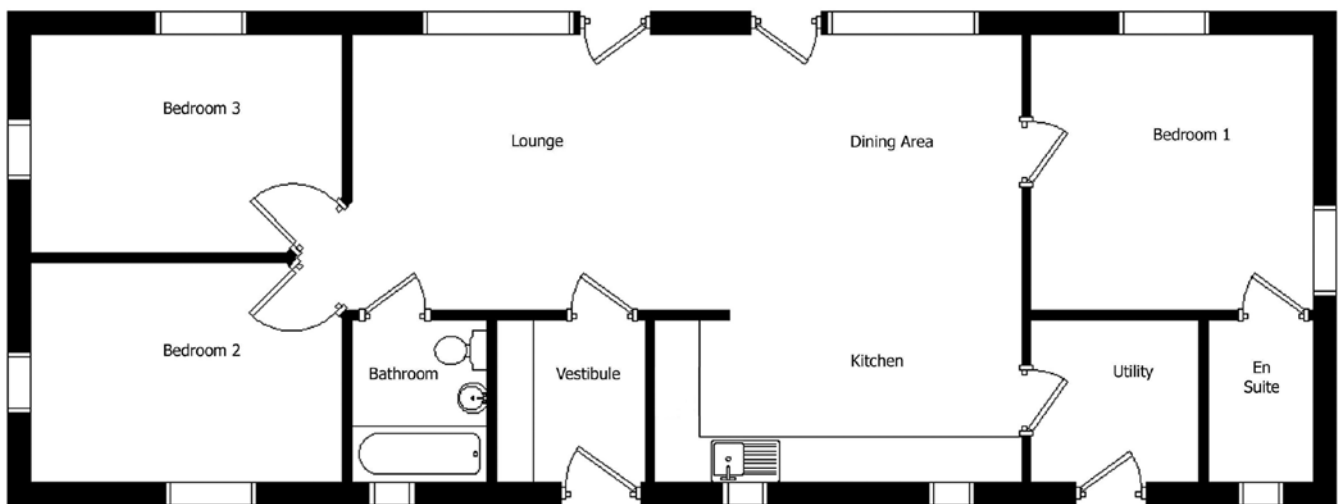

For illustrative purposes only. Not to scale.
Plan indicates property layout only.



Tiriodh	Metres	Feet	Tiriodh	Metres	Feet	Floor Area: 103m2 Frontage: 17.8m Depth: 6.5m Ridge Height: 5.5m
Lounge/Dining	8.9 x 3.7	29'2" x 12'1"	Bedroom 1	3.8 x 3.7	12'5" x 12'1"	
Kitchen	4.9 x 2.1	16'0" x 6'10"	Bedroom 2	4.2 x 2.9	13'9" x 9'6"	
Utility	2.2 x 2.1	7'2" x 6'10"	Bedroom 3	4.2 x 2.9	13'9" x 9'6"	
Bathroom	1.8 x 2.1	5'10" x 6'10"	En-suite	1.4 x 2.1	4'7" x 6'10"	