

CARRICK HOUSE DESIGN



FROM SELF BUILD TIMBER KIT TO NEW HOME

If you're looking at self build houses – then a timber frame kit offers a great way of keeping costs reasonable and the process as quick as possible. We are the largest timber frame design and manufacturing company in the area, for self build projects.

- ✓ NHBC GUARANTEE
- ✓ ECO-FRIENDLY HEATING
- ✓ FOUR BEDROOMS
- ✓ DOUBLE ENSUITE
- ✓ CAR GARAGE

GROUND FLOOR



FIRST FLOOR

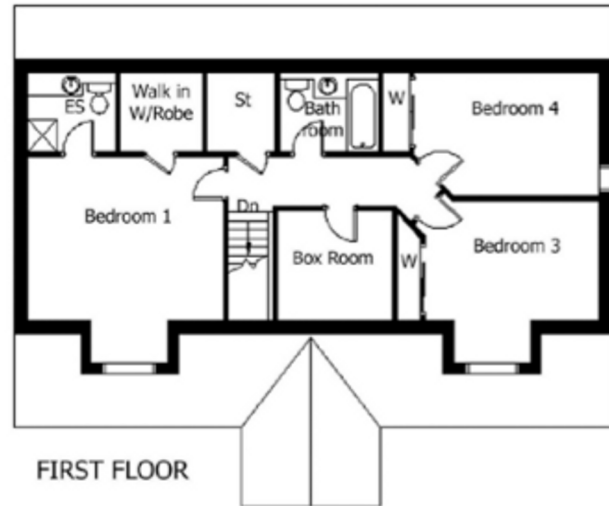

Carrick	Metres	Feet	Carrick	Metres	Feet	
Lounge	5.8 x 4.7	19'0" x 15'5"	Bedroom 3	4.0 x 2.8	13'1" x 9'2"	Floor Area 192m ²
Dining	3.7 x 3.5	12'1" x 11'6"	Bedroom 4	4.2 x 2.8	13'9" x 9'2"	Frontage 13.8m
Kitchen	5.9 x 3.5	19'4" x 11'6"	Boxroom	2.6 x 2.2	8'6" x 7'2"	Depth 10.7m
Utility	3.2 x 2.7	10'6" x 8'10"	Bathroom	2.2 x 1.8	7'2" x 5'11"	Ridge Height 7.8m
Bedroom 1	4.5 x 3.8	14'9" x 12'5"	Shower Room	3.2 x 1.9	10'6" x 6'2"	
Bedroom 2	4.5 x 3.5	14'9" x 11'6"	En-suite	2.0 x 1.8	6'7" x 5'11"	

This beautiful 4 bedroom home could be yours.

MACLEOD
CONSTRUCTION LIMITED