

## CORRAN HOUSE DESIGN



## FROM SELF BUILD TIMBER KIT TO A NEW HOME

If you're looking at self build houses then a timber frame kit offers a great way of keeping costs reasonable and the process as quick as possible. We are the largest timber frame design and manufacturing company in the area, for self build projects.

- ✓ NHBC GUARANTEE
- ✓ ECO-FRIENDLY HEATING
- ✓ FOUR BEDROOMS
- ✓ EN-SUITE

## FLOOR LAYOUT

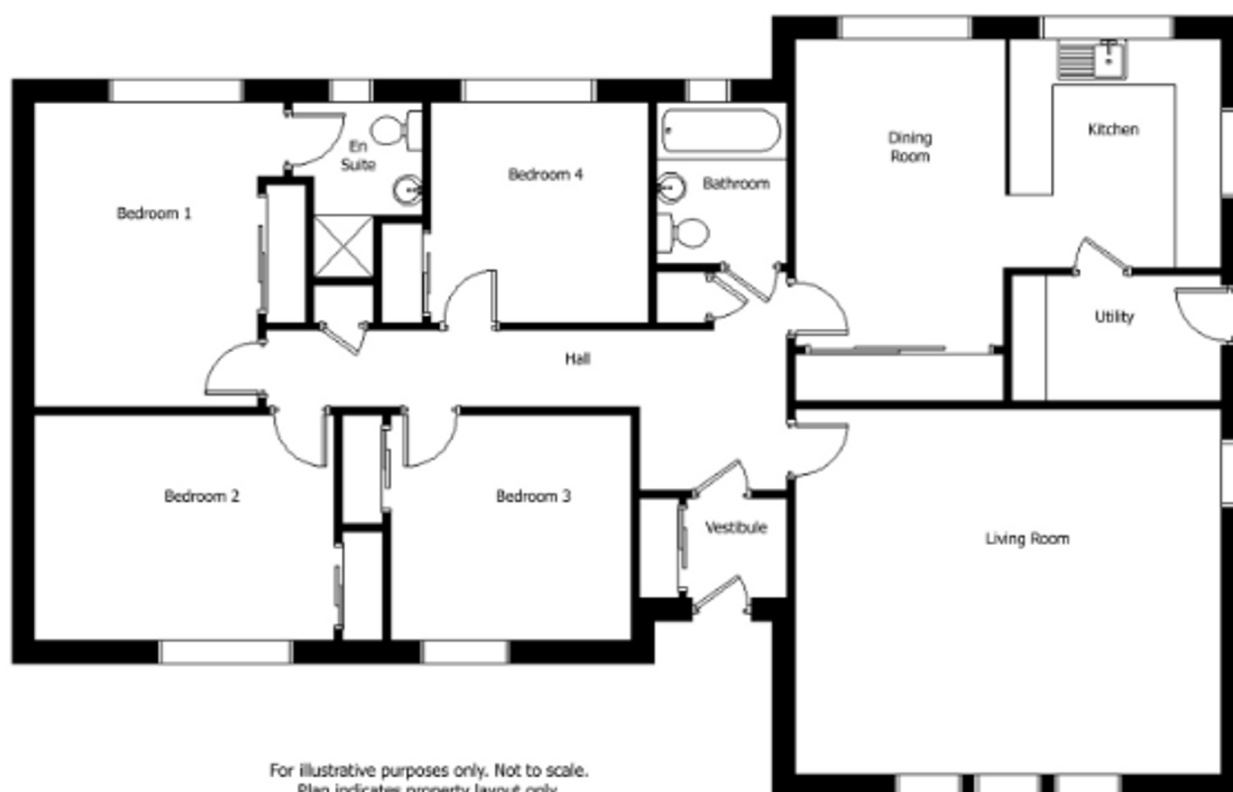

| Corran   | Metres    | Feet          | Corran    | Metres    | Feet          |                                 |
|----------|-----------|---------------|-----------|-----------|---------------|---------------------------------|
| Lounge   | 5.7 x 4.9 | 18'8" x 16'0" | Bedroom 1 | 3.0 x 4.1 | 9'10" x 13'5" | Floor Area<br>129m <sup>2</sup> |
| Dining   | 2.8 x 4.1 | 9'2" x 13'5"  | Bedroom 2 | 4.0 x 2.9 | 13'1" x 9'6"  | Frontage<br>16.6m               |
| Kitchen  | 2.9 x 3.1 | 9'6" x 10.2"  | Bedroom 3 | 3.2 x 2.9 | 10'5" x 9'6"  | Depth<br>10.5m                  |
| Utility  | 2.8 x 1.7 | 9'2" x 5'7"   | Bedroom 4 | 2.9 x 2.9 | 9'6" x 9'6"   | Ridge Height<br>6.1m            |
| Bathroom | 1.8 x 2.1 | 5'10" x 6'10" | En-Suite  | 1.4 x 2.3 | 4'7" x 7'6"   |                                 |

This beautiful 5 bedroom bungalow could be yours.

**MACLEOD**  
CONSTRUCTION LIMITED